



**6973A**

**Adaptadores de cuadrado de 1/4" para punta hexagonal de 1/4"**



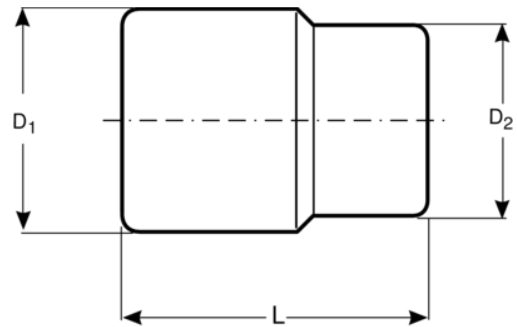

### DETALLES DEL PRODUCTO

- Acabado pulido fino.
- Acero aleado de alto rendimiento
- Adecuado para puntas de 1/4"
- Embalaje en blíster
- Normas: ISO 1174, DIN3120



### ATRIBUTOS DE PRODUCTO

Producto			<b>L</b>	<b>D1</b>	<b>D2</b>	 g
<b>6973A</b>	1/4 in	1/4 in	27 mm	12 mm	12 mm	15 g
<b>SB6973A</b>	1/4 in		27 mm	12 mm	12 mm	15 g

**Follow the Fish!**

